



**KILBIRNIE SCHOOL**  
EST. 1884  
Whāia te iti kahurangi



## **TERM 4. WEEK 8.**

**Welcome to Kaia in Soazik's homeroom.  
Welcome to Rose in Lou's homeroom.**

### **DATES FOR THE DIARY.**

#### **December.**

**Wednesday 6- Bring Your Own Device (BYOD) information evening. 6-7.30pm. Ngake celebration.**

**Thursday 7- Choosing Thursday ends.**

**Monday 11- Year 6 Leavers Dinner.**

**Thursday 14- Thank you morning tea for whānau. 10am. Certificate assembly. 2pm (Matairangi and Whātaimai only). Board meeting.**

**Friday 15- End of year summaries and portfolios go home. New homeroom lists displayed. Year 6 cinema. Whātaimai celebration.**

**Monday 18- New homerooms meet. 9.30-10.30am.**

**Tuesday 19- Last day of term. Poroporoaki final assembly 12.30pm in hall. School closes at 1pm.**

#### **January.**

**Wednesday 31- Welcome back to Kilbirnie School for 2024. Term 1, day 1.**

### **ENROLMENTS.**

Just a reminder about the pre-enrolment of new students. If you have a pre-school child that will be attending our school in the future, please do let the office know. This information is really useful for our planning.



EST. 1884  
**KILBIRNIE SCHOOL**  
Whāia te iti kahurangi

- KILBIRNIE SCHOOL SWIMMING POOL- OPEN NOW!**



## **POOL KEYS NOW AVAILABLE FROM THE OFFICE.**

Keys will not be available for hire after school closes at 1pm on **Tuesday December the 19<sup>th</sup>**

**If you notice people in the pool complex very late in the evening please call the police and report trespass. The pool closes at 8pm each evening.**

The cost for the season is \$90 with a \$10 refund when the key is returned. This fee contributes to the cost of running the pool. Very little money is available from the Ministry of Education for this purpose. The school covers other costs to allow the pool to operate for our students and the community.

Allowing the pool to be used by the school community is a year by year proposition for the school. Maintaining a pool committee with sufficient members is essential. In addition, we really must have a sense of community care and protection of the pool. We ask all users to adhere strictly to the conditions of use. These have been amended for this season and are provided to all key holders. Moreover, we ask users to actively encourage others to do the same. A culture of kaitiaki or shared protection of the redeveloped facility will make it more likely that the pool will be available for public use going forward.





- **CHOOSING THURSDAY.**

The final session of our Choosing Thursday programme is next week. Students and staff had a great time working with new people from across the school in an activity they had chosen to participate in. Ask your child what they have been doing and what they have been learning, it has been a great programme.







"I did the Stuffie making programme with Barbara. First, we designed them and then we did the tacking. After that we learned to do pillow stitch. We put in the stuffing. My one has a rainbow design" – **Mikayla.**

"I made a mythical diorama with Mrs. Patel and Tamara. It has a gold forest and a shape shifting raft. I made pandas for the raft and added mythical trees. There was plenty of glitter" – **Ben B.**





- KILBIRNIE SCHOOL CARE VALUES- EMPATHY.**



Thanks for supporting **Pack the Bus** once again this year. Everyone had the chance to go on the bus and meet the Disney characters that host it.

The bubbles were a highlight for many.

- KILBIRNIE SCHOOL CARE VALUES- ACHIEVEMENT.**



Congratulations to the **Turbos** touch team that won their grade. A great final and well deserved victory.

Congratulations to **Griffin and Jake** who were awarded a gold certificate in Athletics- these are well earned.

Congratulations to **Te Aroha and Winnie** who have qualified to represent the Wellington area at the Regional athletics event. This is the top level of competition for primary school athletics.





- **NEW BUILDING- WHĀTAITAI HUB.**

The new Whātaimai Hub building is nearing completion. The internal fit-out is mostly finished and the concrete walkways around the building will be laid soon. The standard of the internal build is excellent, the learning environment is terrific.

If you have had the chance to look over the fence recently you will have noticed that the ground works and landscaping projects have started. These will continue concurrently as the internal work is finished. The artificial turf and final reinstating of the grass playing areas will extend into the New Year. Whātaimai hub students will occupy the building from the start of the new school year. I will include images in the next newsletter.

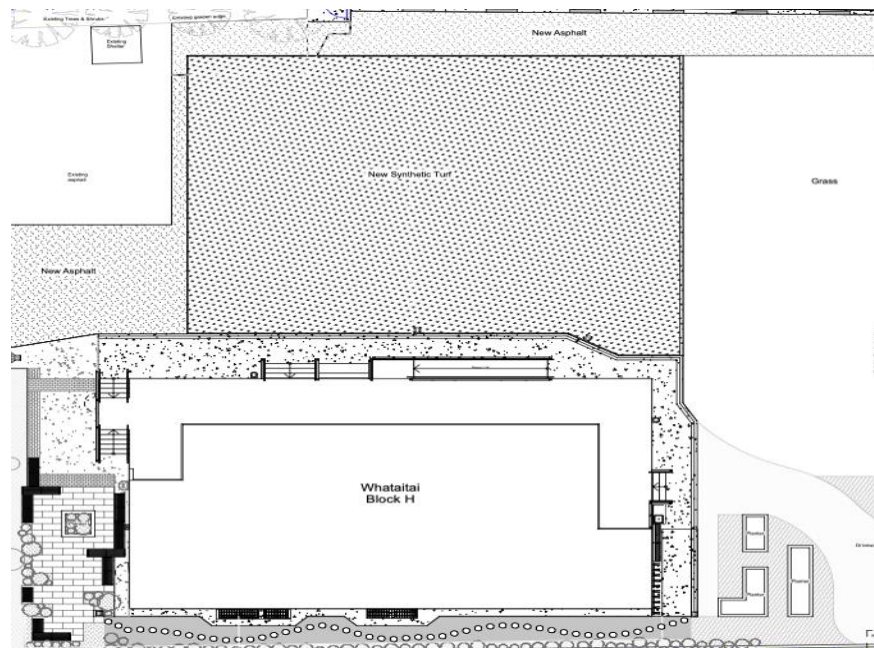



EST. 1884  
**KILBIRNIE SCHOOL**  
Whāia te iti kahurangi

- NEWS FROM KILBIRNIE AFTER SCHOOL CARE.

## **KASC CHRISTMAS**

### **PROGRAMME**

**Baking & Craft's daily**

*20<sup>TH</sup> & 21<sup>st</sup> December*

Email bookings to  
[kasc10@gmail.com](mailto:kasc10@gmail.com)

**\$50 per day**  
**8.30 am to 5.30 pm**





KILBIRNIE SCHOOL  
EST. 1884  
Whāia te iti kahurangi

- NEWS FROM OUR COMMUNITY.



# Open Day



Sunday 10th December  
10.00 am to 3.00 pm  
at Worser Bay Boating Club

Come down to the club and find out about ideas to create a NZL Blue Belt site to help protect marine biodiversity and restore low stocks of marine life at Worser Bay. And while you are there you can have a go at snorkeling with the team from Mountains to Sea Wellington.







# Open Day



Sunday 10th December, 10.00 am to 3.00 pm at Worser Bay Boating Club

Worser Bay Boating Club has been working with schools in the Eastern Suburbs, the NZ Marine Studies Centre, and Mountains to Sea Wellington to establish a NZL Blue Belt Site at Worser Bay. Students have been trialing a set of tools and techniques to monitor ocean health and have been working on a set of ideas to restore marine ecosystems at Worser Bay.



## Ocean Health Monitoring

Find out about the tools that students are using to monitor ocean health at Worser Bay.



## Restoring ecosystems

Find out about projects such as the penguin hotel, the Love Rimurimu seaweed nursery, the anemone garden, and the paua hatchery.



## Have a go at snorkeling

Bring your togs and towel and have a go snorkeling with the Mountains to Sea team - remember to arrive early as spaces fill fast! Wetsuit and all other gear provided.

We'd like to thank the following organisations who are supporting Worser Bay Boating Club and the schools in the Eastern Suburbs to establish a NZL Blue Belt site, and have helped make the open day possible.





## All Saints Christmas Gatherings

### Nine lessons and carols

7pm | Sunday 17 Dec | All Saints Hataitai

Sing along with carols telling the story of Christmas followed by Christmas cake

### Family Christmas Eve

10am | Sunday 24 Dec | All Saints Hataitai

A family friendly Christmas Eve celebration with banging Christmas carols, birthday cake, Christmas message and a whole lot of fun for everyone

### Midnight Christmas Eve

11pm | Sunday 24 Dec | All Saints Hataitai

A special traditional candlelight Christmas Eve service

### Christmas Day

9am | Monday 25 Dec | All Saints Hataitai

An all age family Christmas day celebration - bring your whole family

allsaints





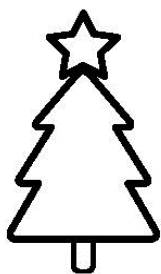

# KIDS CHRISTMAS BAKING CLASSES



WITH SARAH HALEWOOD

Perfect for kids age 10 to 14

---

Drop your kids off to do some Christmas baking while you shop or simply enjoy some quiet time. They will bake, decorate and package up a range of delicious Christmas treats, perfect for gifting to friends and family. Each child will bring home 6 packaged gifts, containing a selection of goodies.

---

## DETAILS

**Sunday 10th December** 10am - 1pm **\$125**

### On the menu:

Spiced Christmas Biscuits

Rocky Road

Raspberry Jam

**Saturday 16th December:** 10am 1pm **\$125**

### On the menu:

Pinwheel Biscuits

Chocolate Truffles

Marmalade

## WHERE

Prefab Hall - 14 Jessie Street Te Aro

## TO BOOK EMAIL

sarahhalewood8@gmail.com



## The Volleyball Academy VolleyKids

*This package is tailored for the fundamental development of volleyball skills. There are two programs separated by age. The younger group is available for children ages 7-10. The older group is for ages 11-13.*

*Age group 7-10: Saturdays 9am – 10am  
Age group 11-13: Saturdays 10am – 11am*

*The program will run for 9 weeks (no session on the 30<sup>th</sup> of March due to Easter Weekend). All sessions will be at Wellington Girls College. Both programs will be capped at 20 athletes each. Once filled, registrations will close.*

**Account Name: The Volleyball Academy Ltd.  
Account No: 06-0513-0899429-00**

**Package Cost \$150**

**Contact Coach Jo for more information.**

**Phone: 02102493755**

**Email: j\_delgado10@live.com**

### ⊕ Session Dates - Saturdays

Date	Location
10 <sup>th</sup> February	Wellington Girls College
17 <sup>th</sup> February	Wellington Girls College
24 <sup>th</sup> February	Wellington Girls College
2 <sup>nd</sup> March	Wellington Girls College
9 <sup>th</sup> March	Wellington Girls College
16 <sup>th</sup> March	Wellington Girls College
23 <sup>rd</sup> March	Wellington Girls College
6 <sup>th</sup> April	Wellington Girls College
13 <sup>th</sup> April	Wellington Girls College

**WELLINGTON  
MUSIC  
CENTRE**

## Enrolments are open for 2024!

Get a full year of lessons for just \$120

WMC has been providing affordable music lessons to the Welly community for over 40 years, spreading the joy of music, and breaking down cost barriers to music tuition.

Your tamariki can learn any of our 12 instruments, with beginner classes available on *keyboard, guitar, strings, winds, brass, percussion and harp*. We also offer a special Music Explorers class to give our 5 and 6-year-old students a fun start in music!



**Sign up online today:**

[www.WellingtonMusicCentre.org.nz](http://www.WellingtonMusicCentre.org.nz) 

[contactus@wellingtonmusiccentre.org.nz](mailto:contactus@wellingtonmusiccentre.org.nz) 