



TERM 3. WEEK 2.

Welcome to **Max and Sione** in Mrs. Patel's Homeroom.

DATES FOR THE DIARY.

August.

- **Thursday 3- Board meeting 7pm.**
- **Thursday 10- school hui (assembly).**
- **Wednesday 16- Learning conferences day 1.**
- **Thursday 17- Learning conferences day 2.**
- **Wednesday 23-Eastern Zone swimming.**
- **Thursday 24- school hui (assembly).**
- **Thursday 31- school photo day.**

September.

- **Thursday 7- school hui (assembly) and Board meeting 7pm.**
- **Monday 11- Art splash choir- concert.**
- **Friday 15- Parentlink Quiz Night.**
- **Saturday 16- Art Te Aroha- exhibition of student work in school hall. 9.30am-12pm.**
- **Monday 18- Art Te Aroha- exhibition of student work in school hall. 8.30am-3.00pm.**
- **Wednesday 20- Eastern Zone floorball.**
- **Friday 22- Last day of term 3.**

PRINCIPAL NEWS.

Art te Aroha this term.

In the New Zealand Curriculum, the arts learning area is comprised of four disciplines: dance, drama, music and the visual arts. At Kilbirnie School we believe all of these aspects of the arts are important in a rich, engaging education. We believe all our students should have the opportunity to participate, experience and enjoy the arts. We want students to be creative in their own art and appreciative of art made by others.

Through the arts students learn to participate, take risks, create, innovate, develop confidence, express ideas and respect the efforts of others. Students also take great satisfaction and enjoyment from learning in the arts.

Our bi-annual celebration of the visual arts involves every child and is called **Art te Aroha**. This year we are not showing professional art, our exhibition in September will feature work from every student at our school. Mark the dates!

Tony Austin- Principal.



- **KILBIRNIE SCHOOL LEARNING CONFERENCES- TERM 3.**

Wednesday August 16th and Thursday August 17th.

At the start of term one we offered parents an opportunity to meet with classroom teachers to learn about classroom and hub programmes. Early in term two we held individual meetings or conferences focussing on your child's learning and goals. We now hold a second conference to discuss progress and new learning goals.

At Kilbirnie School we operate a three-way conferencing system throughout the school. This involves the parent, child and teacher. This approach is consistent with our school wide goal of developing independent, reflective learners. Our graduate profile expresses our focus on developing engaged students who assume responsibility for their own learning. Obviously, our work to develop these competencies is very different depending on readiness of the learners, this includes the conferencing process.

We use an online booking system for the conferences which are 15 minutes in duration. This will be available from **6.00pm this Monday July 31**. Visit the following website and use our event code.

www.schoolinterviews.co.nz

Event code: 2vugd

Normal classes will finish at 2.00pm on 16th and 17th allowing conferences to commence at 2.15pm. Students are permitted to go home at 2.00pm if accompanied by an adult. Teachers will also dismiss students who have written or emailed permission from a parent. All other students will be supervised until 3.00pm.

Ngake students will be in their hub while Whāitaitai and Matairangi students will be in the hall. If your child's conference is between 2.00pm and 3.00pm please collect them from the hall in time to get to the classroom for the meeting.



EST. 1884
KILBIRNIE SCHOOL
Whāia te iti kahurangi

- **MATARIKI CELEBRATION.**

Our celebration of Matariki, Māori New Year featured learning activities throughout the school day and a wonderful Parentlink community event in the evening. A highlight was working with mixed groups of students from across the school, I was so impressed with the support provided to our younger students by the older children.

On Thursday this week our kapa haka rōpū performance whānau, teachers and students. Just fantastic! Acknowledgements to whaea **Rachel France** and also **Lou and Barbara** for their support of the tamariki.





- **A MESSAGE FROM OUR STUDENT COUNCIL.**

I recently met with **Nixon and Walter** from our student council. They had been around the homerooms to discuss a recycling project with the students. They asked me to advertise this project to our school community.

“Please collect your plastic bottle tops which have a number 2 or 5 inside the lid. We are recycling these. They are made into other things. Find these on things like milk bottles and fizzy drinks. Collection boxes at the office or in Lou’s homeroom. Thank you”.

**Nixon and Walter-on behalf of the
Kilbirnie School student council.**





EST. 1884
KILBIRNIE SCHOOL
Whāia te iti kahurangi

• **WHĀTAITAI BUILDING REPLACEMENT- OUTSIDE SPACES FUNDRAISER.**

Thank you for the support with this! We are working very hard to generate funding for the different projects in the areas around the building. The clay and Lego bricks will be available until October unless sold out before that.



EST. 1884
KILBIRNIE SCHOOL
Whāia te iti kahurangi

Cement Your Support > **BUY A BRICK**

Notice our School under construction? We're transforming the surroundings of the new building into outdoor learning and socializing areas for students and whānau. The West and East sides offer great potential for outdoor learning and inviting communal spaces. To finance these initiatives, we've created two community opportunities.

1. Engraved red clay bricks in the outdoor area paving.
2. Engraved Lego bricks as part of a wall inside.

By purchasing a named engraved brick in the Kilbirnie School WHĀTAITAI Walkway (pictured below), you can both support future students, and also create a very special permanent legacy on the school grounds for you, your child(ren) and their whānau to return to now, and for generations to come.

Current and past students, parents and all whānau across the country and world, supporters of Kilbirnie School, organisations and of course all local businesses are invited.

Engrave your name here...

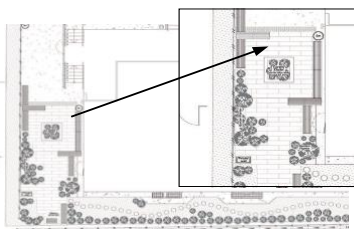
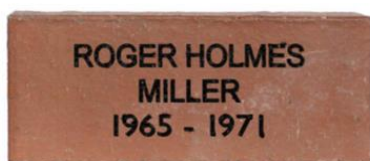

BUY A LEGO BRICK

We are going to build a Lego wall inside the new building. The wall below (with the pink border) has been identified by the architect for the framed display of individual 8x2 Lego bricks which will be engraved. See below for examples.

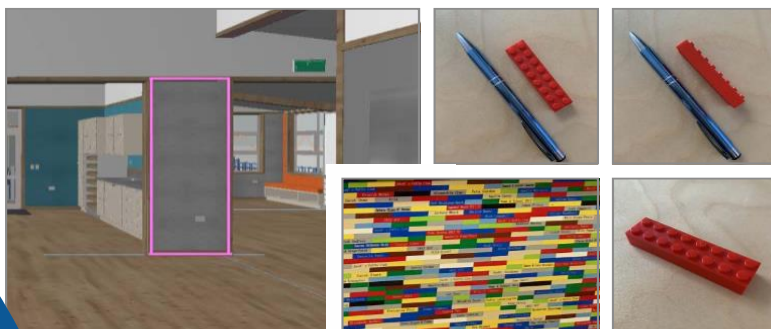

Details...

Clay Brick / **\$150**
tax deductible.

Maximum of 3 lines,
16 characters including
spaces on each line.
Can purchase multiple.

Lego Brick / **\$35**
tax deductible
4mm x 9mm x 15mm.

Maximum of 20
characters including
spaces, one line.
Can purchase multiple.

To order, please fill out
an order form available
from office or via email.

For more details and
FAQ's see Kilbirnie.
school.nz

Any queries please
email [office@kilbirnie.
school.nz](mailto:office@kilbirnie.school.nz)



You will notice that the new building now has a roof! These drone images were captured earlier.



- AROUND THE SCHOOL.**

What a pleasure to speak with **William, Tom, Winnie and Rory** as they explained the connections between their waka model and the inquiry learning investigation they did last term.

The learning was deep and the model- spectacular!

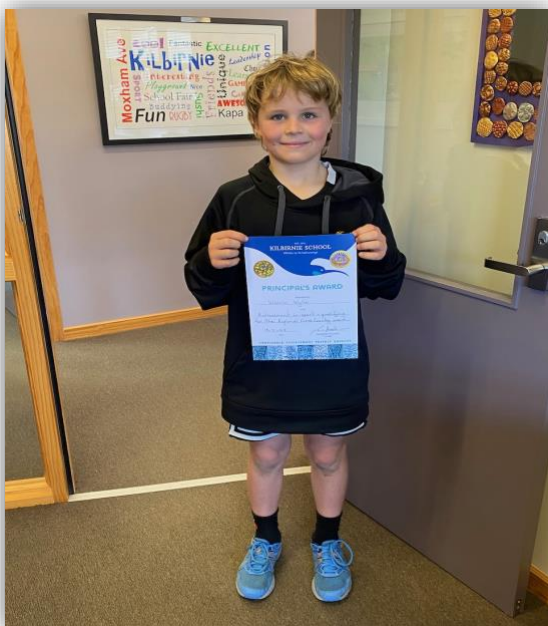

Congratulations to **Winnie** who qualified through all of the levels of cross-country running competitions to represent the Wellington region at the regional event recently. Getting to this level is an exceptional achievement.



• **SCHOOL PHOTOS THIS TERM.**



Inspire Photography will be coming to photograph the children at Kilbirnie School from 9am on:

Thursday 31 August 2023

As part of Kilbirnie School's fundraising for the year Inspire Photography will donate 10% of all sales directly to Kilbirnie School.

Inspire Photography is an award-winning, Wellington-based professional photography studio who specialise in School and ECE photography. We are popular throughout a number of Wellington Schools for the photographs we take, the manner in which we take them and our generous fundraising offers. We are unique in our style and approach.

What we offer on the day

- A totally relaxed and unique style of photography
 - A friendly and easy-going photographer
- Fun, games and general silliness to get even the shyest children smiling
 - Group photos of each class
- Individual portraits, friend portraits and siblings photos.

To view the pictures, we offer an online ordering system. The School Office will be advised of the password for the online gallery when the proofs are ready. Proofs are available to view online approximately two weeks after the date of the photo shoot, you will then have two weeks to place an order and two weeks after orders will be delivered back to the School. If you would prefer not to order online, please contact us in the studio for assistance.

Product	Standard Price	Multibuy 3+
Size AA - 4x 2x3" (5x15cm)	\$22.00	\$15.00
Size A - 6x4" (10x15cm)	\$17.00	\$15.00
Size B - 7.5x5" (12.5x20cm)	\$20.00	\$17.00
Size C - 12x8" (20x30cm)	\$30.00	\$25.00
Size D - 10x15" (24.5x37cm)	\$45.00	\$30.00
10x8" Group Laminate	\$19.00	\$17.00
Package 1 - AA + A + B	\$30.00	-
Package 2 - Class Photo + B	\$30.00	-
Package 3 - Class Photo + AA + A + B	\$45.00	-
Whānau Package - 3 x B	\$45.00	-
HIGH Res Digital File	\$40.00	\$30.00

Creative Portraits for Modern Families

Courtyard, Level 1, Studio 3, 177B Thorndon Quay, Pipitea, Wellington.
Phone 04 384 8009 Web www.inspirephotography.co.nz



EST. 1884
KILBIRNIE SCHOOL
Whāia te iti kahurangi

- **NEWS FROM OUR COMMUNITY.**

If your child loves doing cartwheels, handstands, trampolining, flips, dancing, or parkour, then they will thrive at Bigair Gym!

Bigair Gym classes are excellent for fun, focus and fitness! Children learn new skills and develop personal confidence and self-achievement! Strong focus is given to safety and technique, ranging from fundamentals to advanced skills. The structured classes follow a Bigair Badge Programme, which creates focused learning, and allows children to achieve and feel personal progression! Bigair classes include **GYMNASTICS, TRAMPOLINING, TUMBLING, FREE RUNNING** (thats parkour with flips) & **CHEERLEADING!** Inquire about Bigair **BIRTHDAY PARTIES** too!

Bigair Gymsports Kapiti ph. 297 0400 e. kapiti@bigairgym.co.nz

Bigair Gym Owhiro Bay ph. 383 8779 e. wgt@bigairgym.co.nz

Bigair Gym Tawa ph. 232 3508 e. office@bigairgym.co.nz

Suzanne Aubert Scout Group

Develop teamwork, life skills, personal resilience whilst having fun in the outdoors.

The Suzanne Aubert Scout Group is open to both girls and boys: Keas (aged 5 – 8), Cubs (aged 8 – 11) and Scouts (aged 11 – 14) on Monday nights 6.30 – 8pm at St Anne's Hall, 22 Emmett St Newtown.

This terms activities include: camping, campfire cooking, mountain biking, outdoor adventure, archery and swimming. Come along and join the adventure.

For more details email SuzanneAubert@group.scouts.nz.

